

**Pro LED Video Light
YN 300-II
User Manual**

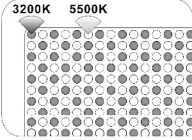
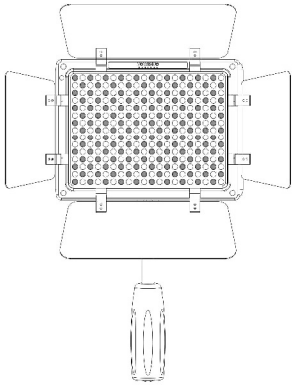

Please read manual carefully before using the product and keep it properly for future reference.

Summary

First of all, thank you for using YN300-II LED camera light. This camera light is formed by 150 LED lamp beads with 5500k color temperature and another 150 LED lamp beads with 3200k color temperature. You can adjust the brightness ratio between them to get the color temperature you want. It adopts the encoder digital dimming code, thus the camera light can be dimmed accurately and reliable, and will not lead to undesirable effects such as light shaking after long-time use besides, the camera light is equipped with powerful functions of battery power test, remotely controlling and adjusting the brightness wirelessly, etc.

I. Product Structure

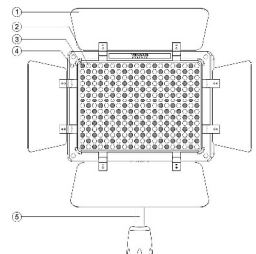

1. Reflector
2. 5500k Color Temperature LED lamp beads
3. 3200k Color Temperature LED lamp beads
4. Front IR Receiver
5. Handle
6. Battery Lock Button
7. Adjusting Screw
8. Hot Shoe Fastening Knob
9. Metal Hot Shoe Base
10. Mini-type Base
11. Functional Indication Lamp
12. Rear IR Receiver
13. Power Switch/Brightness Adjusting Rotary Button
14. 5500k color temperature Button
15. 3200k color temperature Button
16. Electric Quantity Testing Pushbutton
17. Fine-adjusting Switch Button
18. Pilot Lamp

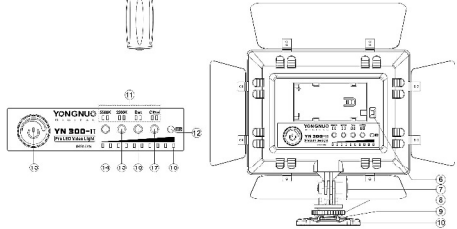

II. Function Introduction

1. YN300-II adopts high quality LED lamp beads of extra-large luminous chips, the brightness is brighter, the light spot is more evenly and the service time is longer.
2. The color temperature of YN300-II can be adjusted from 3200-5500K, which meet your needs of more shooting situations.
3. YN300-II adopts the encoder digital dimming which can be separately adjusted to rough dimming and fine dimming modes, more convenient to use.
4. The infrared remote controller is configured, thus the brightness and power switch can be adjusted away from the machine.
5. Adopted the professional LED driving chip, the light is stable and the efficiency up to 93%.
6. The camera light can be mounted on the camera as well as used by a handle.
7. Four color temperature plates are configured and suitable for use under different environments.

III. Method of Application

1. Battery Installation

When the lithium battery is mounted, the battery should be mounted to the card groove according to the arrow direction.

- | | | |
|---------|-----------|-----------|
| NP-F550 | NP-F550 | NP-F950/B |
| NP-F530 | NP-F770 | NP-F970/B |
| NP-F570 | NP-F770 | NP-P960 |
| NP-F930 | NP-F930/B | NP-F950 |
| NP-F330 | | |

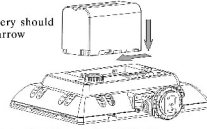

Note: It is recommended to use the battery with capacity of more than 400mah, which can be used for about 90 minutes under the highest brightness, capacity of 2200mah can be used for about 40 minutes under the highest brightness, and capacity of 5800mah can be used for about 130 minutes under the highest brightness. The battery should be taken off when it is out of service.

When the lithium battery is dismounted, please press the Battery Locking Button, and then take off the lithium battery.

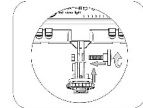
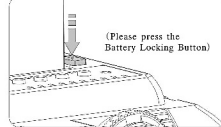

2. Camera Lamp Installation

First fasten the lamp base to the bottom of the product with the adjusting screw and then adjusting the angle of the lamp as needed.

3. The camera lamp can be fastened as follow as needed.

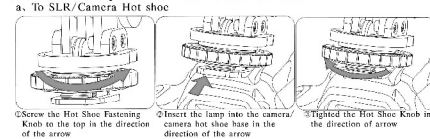

① Screw the Hot Shoe Fastening Knob to the top in the direction of the arrow

② Insert the lamp into the camera/camera hot shoe base in the direction of the arrow

③ Tighten the Hot Shoe Knob in the direction of arrow

b. To Attached Mini Base Put on the Desktop or Other Flat Surfaces.

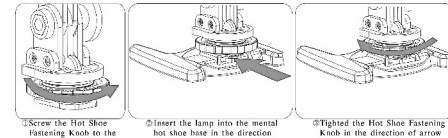

① Screw the Hot Shoe Fastening Knob to the top in the direction of the arrow

② Insert the lamp into the metal hot shoe base in the direction of the arrow

③ Tighten the Hot Shoe Fastening Knob in the direction of arrow

c. To Lamp Holder/Tripod

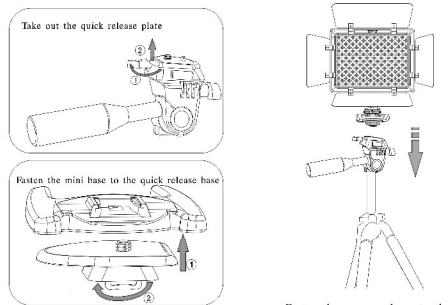

Take out the quick release plate

Fasten the mini base to the quick release base

Fasten the camera lamp to the tripod

d. To the Attached Handle

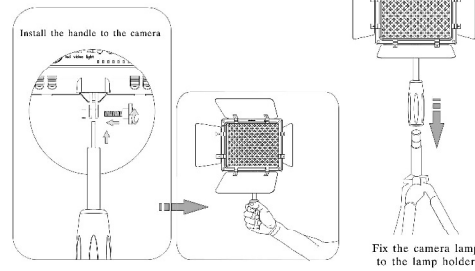

4. Start up and Manual on

a. Press the power switch and light the LED camera light, rightwards rotate to increase the brightness, or leftwards rotate to reduce the brightness;

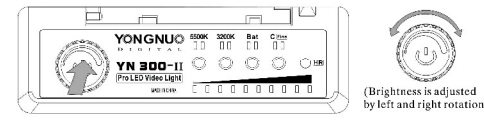

(Brightness is adjusted by left and right rotation)

b. Switch to fine-adjusting mode through C Fine pushbutton, thus the brightness regulation become very fine to satisfy your higher adjusting requirement.

4. Color Temperature Adjustment

Slightly press the 5500k pushbutton and rotate the brightness adjustment knob to adjust the 5500k Color Temperature LED lamp beads

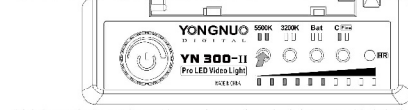

Slightly touch the 3200k pushbutton to adjust the brightness of 3200k Color Temperature LED lamp beads. You can adjust the brightness ratio between them to get the color temperature you want from 3200k to 5500k.

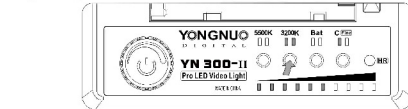

5. Test of Electric Quantity

Bat pushbutton is slightly touched, the pilot lamps are lighted in order; the displayed quantity is the remaining electric quantity. (Note: the power test with low brightness is different from that with high brightness, thus the service time is tested under the current brightness)

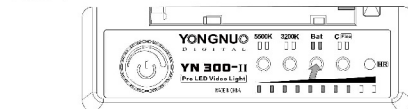

IV. CT Filters

This product comes with 4 CT filters. Simply insert the CT filters into the color temperature chip card slot of the product to meet your requirement in different environments.

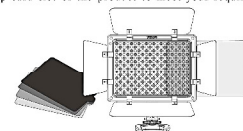

V. Remote Control Mode

a. The product comes with multifunctional IR remote control can adjust the luminance and switch. Aim the remote control at the front or back of this product which is equipped with one IR receiver respectively to adjust the luminance at a remote control less than 8 meters.

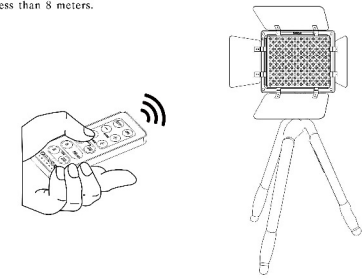

b. The multifunctional IR remote control can also control Canon, Nikon, Sony SLR with infrared reception.

VI. Product Specification

Light Source	300 LED beads	Luminance Angle	55°
Color Temperature	3200k—5500k	Average Service Life	50000H
Color Rendering Index	>90%	Remote Control Distance	<8M
Power	18W	Weight	725g
Lumen	2280 LM	Size	173*153*43

Contents: Camera light (1), Multifunctional IR Remote (1), Handle (1), Light foot (1), Storage Bag (1), Mini Base (1), User Manual (1), CT Filters (4)
Note: Please contact your dealer if anything is missing.

VII. Failure Analysis and Troubleshooting

In using this product, you may encounter the following problems.

Description	Cause	Trouble-shooting
No reaction after power on	Low Battery	Install new batteries or charge the batteries for use
Inadequate or low luminance at the highest grade	Damaged circuit board	Depot repair
Inaccurate Battery capacity test; low battery in high luminance and full in low luminous	The battery capacity indicates the length of time available for the use of the current luminance. Higher luminance required more power and shortens the length of time available for use, so the battery capacity shown is lower	Normal phenomenon and no measure needed
The camera lamp can not be remote controlled	Fail to aim at the IR receiver or too far away	Aim at the camera and less than 8 meters
Multifunctional remote control fails to remote control the shutter	The IR reception function is not turned on	Enable the IR reception according to the User Manual of the camera

Hong Kong Yong Nuo Photographic Equipment Co., Ltd
Address : G/F,4 Bulkeley Street, Hung Hom, Kowloon, Hong Kong
After-sales : service@hkyongnuo.com
Tel:(86)755-837-62448
Web site:www.hkyongnuo.com
www.yongnuo.com.cn